

ADVANCED

HOUSE PLANS



30313 - Arvada Data Sheet

2219
SQ FT

3
BEDS

3
BATHS

2
BAYS

59' 4"
WIDE

49' 0"
DEEP

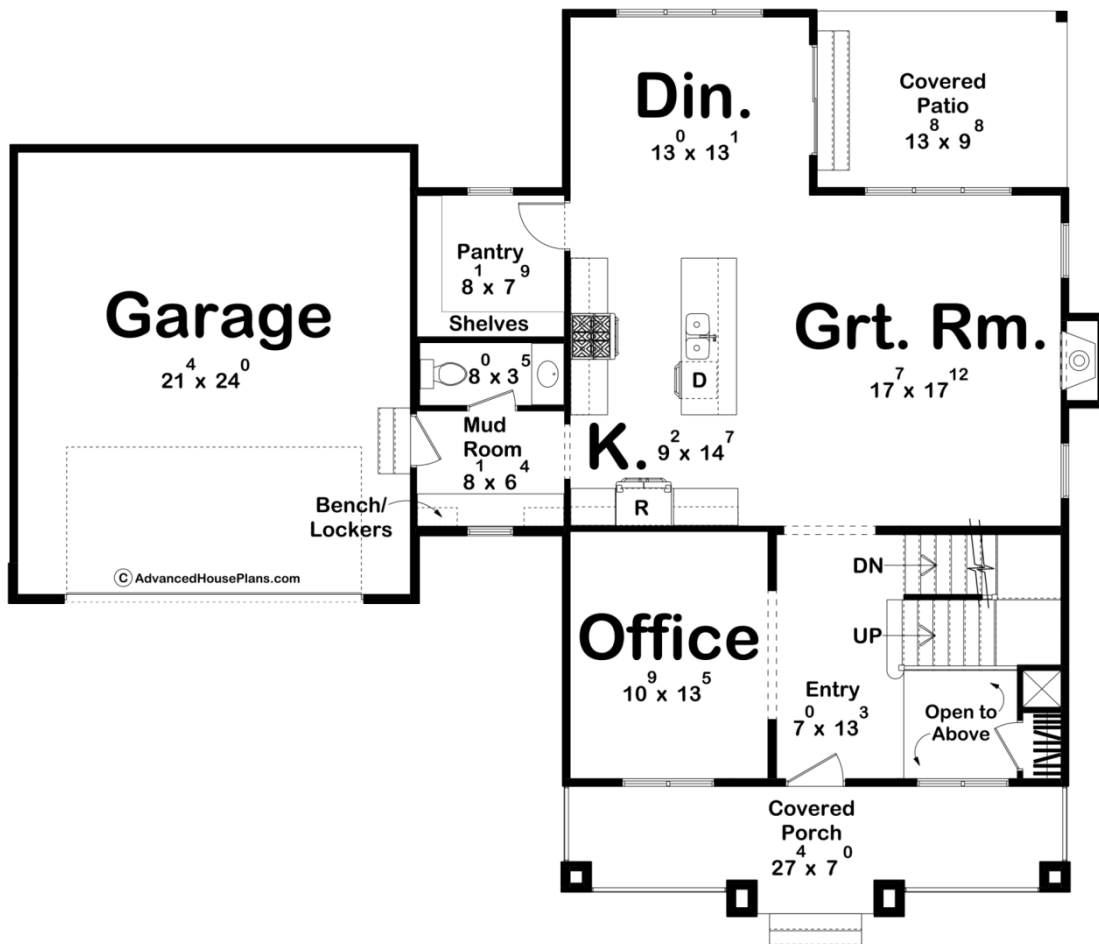

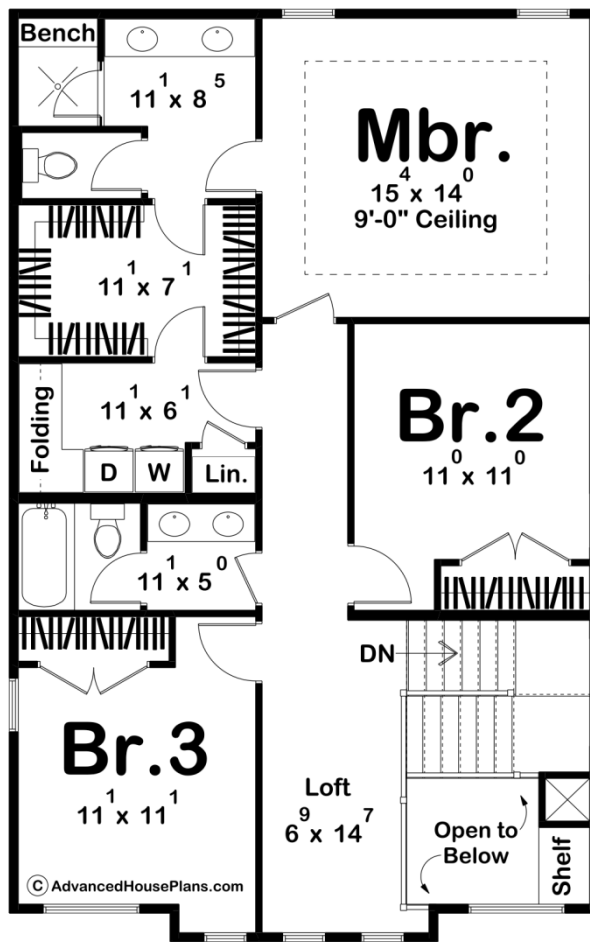

Construction Specs

Layout

Bedrooms	3
Bathrooms	3
Garage Bays	2

Square Footage

Main Level	1168 Sq. Ft.
Second Level	1051 Sq. Ft.
Covered Area	302 Sq. Ft.
Garage	536 Sq. Ft.
Total Finished Area	2219 Sq. Ft.

Exterior Dimensions

Width	59' 4"
Depth	49' 0"
Ridge Height	23' 3"
<i>Calculated from main floor line</i>	

Default Construction Stats
Stats are unique to the individual plan.

Foundation Type	Basement
Exterior Wall Construction	2x4
Roof Pitches	Primary 4/12, Secondary 6/12
Foundation Wall Height	9'
Main Wall Height	9'
Second Wall Height	8'

Plan Description

Love this floor plan? Check out these alternate elevations.[30311 Longmont](#)[30309 Loveland](#)[30312 Northglenn](#)Welcome to the epitome of modern prairie living with this meticulously designed house plan. As you step through the inviting front door, you're immediately greeted with the essence of contemporary comfort and classic aesthetics. The architectural beauty of the prairie style is evident in every thoughtful detail.To your right, an elegant staircase gracefully ascends, inviting you to explore the upper levels of the home. On the left, a versatile office space awaits, perfect for those seeking a tranquil haven for work or study. The juxtaposition of the staircase and the office sets the tone for the balance of form and function that characterizes this residence.Moving forward, the interior unfolds into an expansive great room that seamlessly merges with the contemporary kitchen, creating an open-concept living area that's perfect for both entertaining and everyday life. The great room's abundant natural light and carefully selected finishes evoke a sense of warmth and relaxation, while the kitchen's clean lines and state-of-the-art appliances are a testament to modern convenience.Nestled discreetly toward the rear of the main floor is the dining area, a cozy nook that offers intimacy and a connection to the surrounding landscape. With direct access to the rear covered patio, it's an ideal spot for enjoying meals al fresco while soaking in the sights and sounds of nature.The kitchen boasts a walk-in pantry, a haven for culinary enthusiasts to store essentials and experiment with ingredients. Nearby, the mudroom provides a practical transition space, linking the interior to the convenience of a two-car garage. It's an organized oasis for shedding outdoor gear and maintaining the home's pristine interior.As you ascend the staircase to the upper level, you'll discover a haven of tranquility and rest. Three bedrooms await, each exuding its unique charm and comfort. Two of the bedrooms share a well-appointed hall bathroom, promoting a sense of community and convenience. The master suite, a true retreat, boasts its own private bathroom and an expansive walk-in closet. It's a space designed to cater to your every need and provide a sanctuary for relaxation.Throughout the house plan, the modern prairie style's signature characteristics are thoughtfully woven: the horizontal lines, hipped roofs with broad overhanging eaves, and the seamless integration with the surrounding environment. This house plan captures the essence of prairie style architecture while embracing the contemporary lifestyle, offering a harmonious blend of form and function that is bound to delight and inspire all who call it home.