

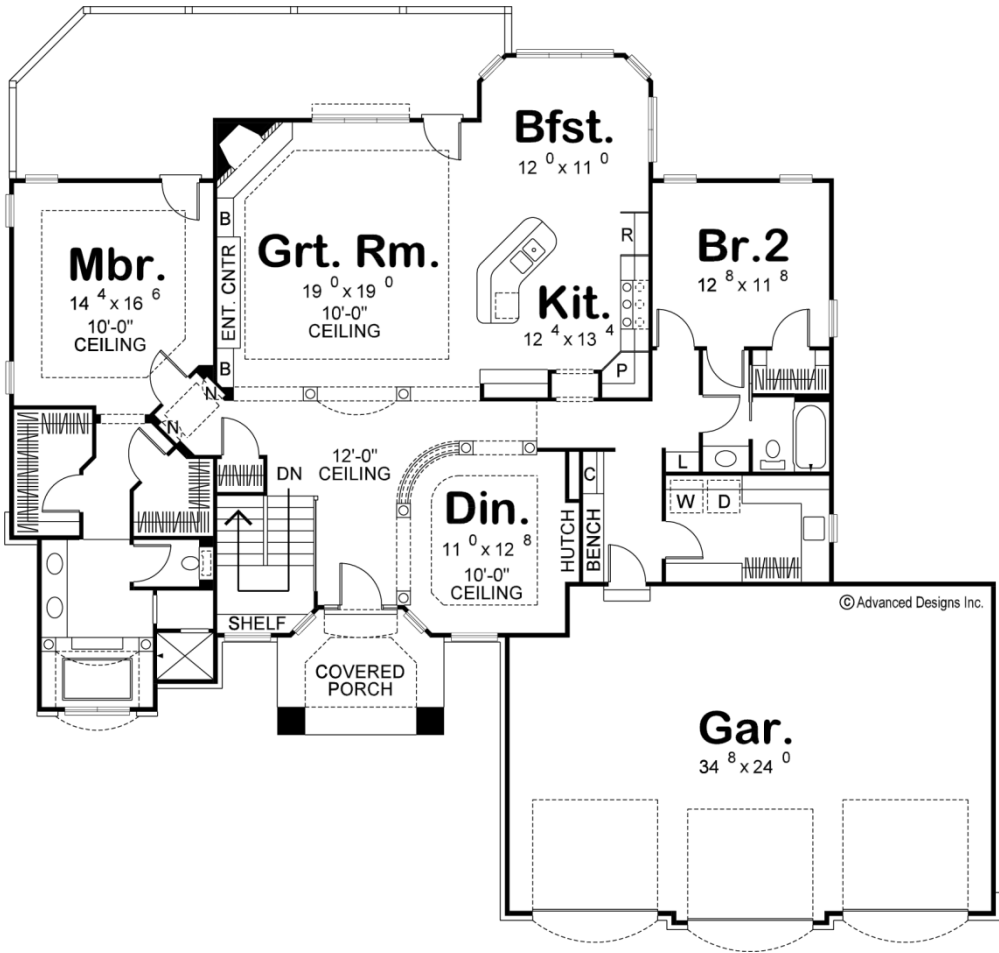

29135 - Banberry Data Sheet

2112 SQ FT	2 BEDS	2 BATHS	3 BAYS	71' 0" WIDE	63' 0" DEEP
---------------	-----------	------------	-----------	----------------	----------------



Construction Specs

Layout
--------

Bedrooms

Bathrooms	2
Garage Bays	3
<b>Square Footage</b>	
Main Level	2112 Sq. Ft.
Garage	833 Sq. Ft.
Total Finished Area	2112 Sq. Ft.
<b>Exterior Dimensions</b>	
Width	71' 0"
Depth	63' 0"
Ridge Height <i>Calculated from main floor line</i>	20' 0"
<b>Default Construction Stats</b> <i>Stats are unique to the individual plan.</i>	
Foundation Type	Basement
Exterior Wall Construction	2x4
Roof Pitches	6/12
Foundation Wall Height	9'
Main Wall Height	9'

## Plan Description

Classic Mediterranean styling is accented by a tasteful blend of textures on this 2,112 sq. ft., 1-story house plan. Stout columns stand at attention on the covered front porch and act as a centerpiece of the home's curb appeal. Inside, guests are treated to open views throughout much of the home's living space.

Ceiling details and elegant columns define the outer boundary of the formal dining area, which lies just off the entry. Additional columns and arched detailing beckon entry into the great room, with its corner fireplace and built-in entertainment center and bookcases. The kitchen and breakfast area lie open to the great room and feature an island workspace and a walk-in pantry. From this area, a rear deck with built-in hot tub is accessed. A few steps from the kitchen can also lead to a generously sized laundry room with counters and soaking sink. Just outside the laundry room, a mud area with built-in bench and coat closet offer access to the home's 3-car garage. The master is situated for privacy and designed for comfort. The bath area features two separate walk-in closets, dual sinks, compartmented toilet, shower and an opulent soaking tub, set between elegant columns beneath a barrel-vault ceiling.