

# ADVANCED

HOUSE PLANS



## 29817 - Bridgeport Data Sheet

2388  
SQ FT

3  
BEDS

2  
BATHS

2  
BAYS

72' 8"  
WIDE

59' 0"  
DEEP

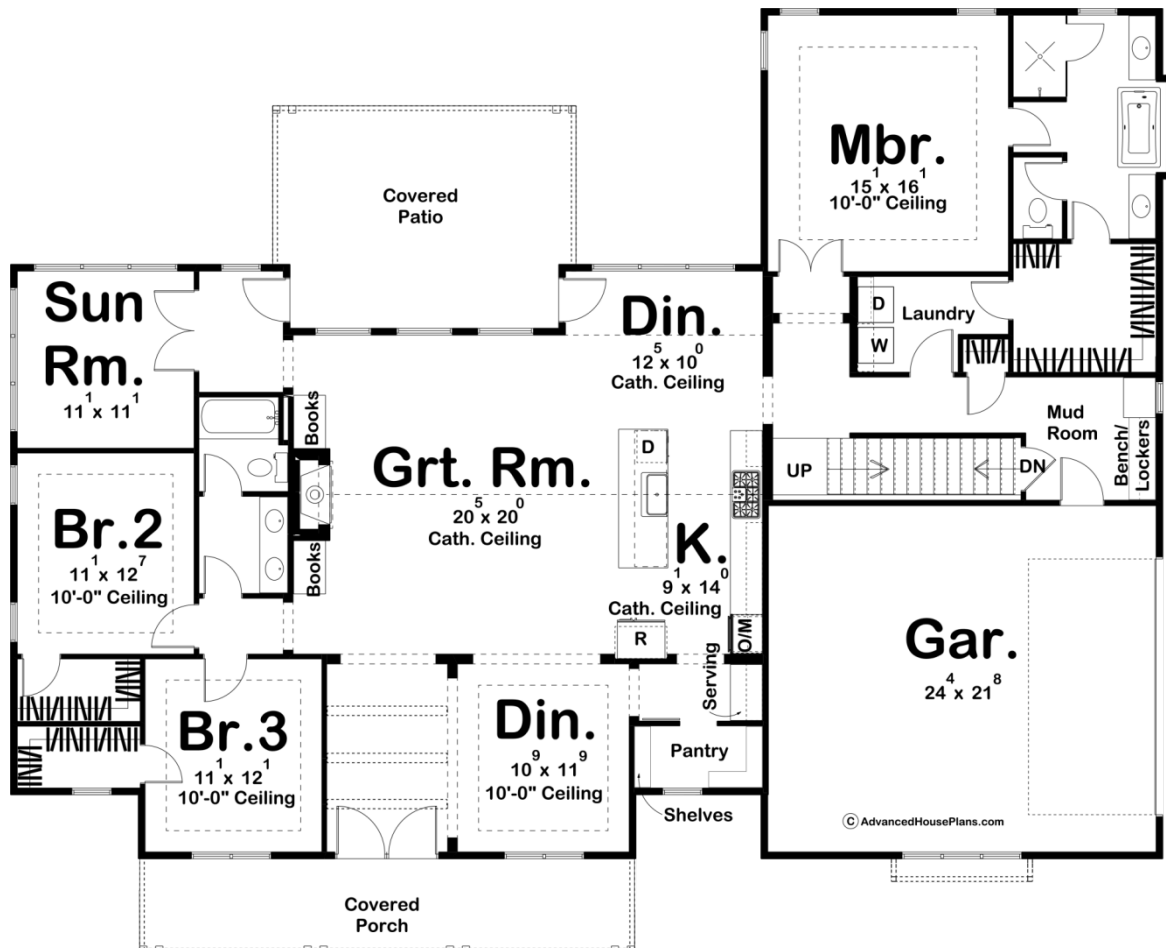

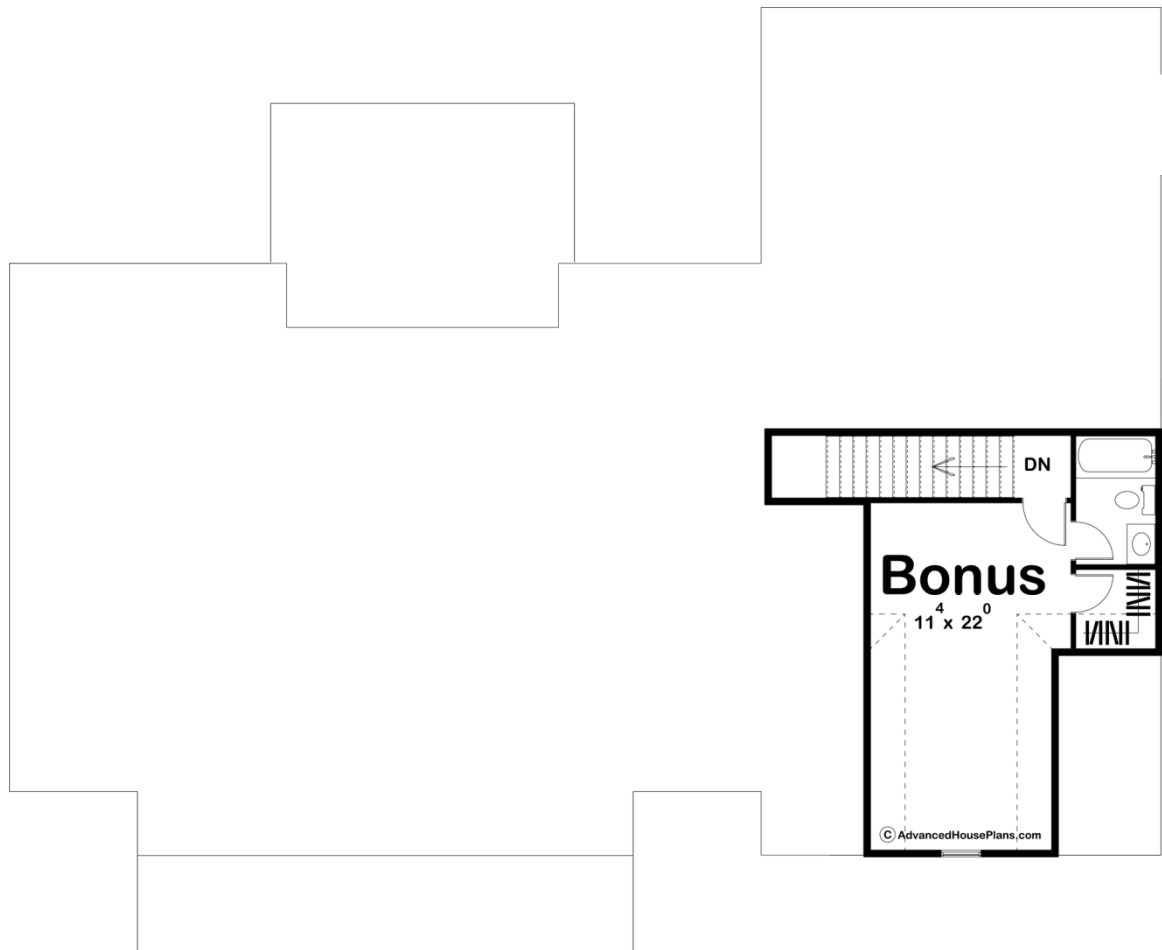

## Construction Specs

### Layout

Bedrooms	3
Bathrooms	2
Garage Bays	2

### Square Footage

Main Level	2388 Sq. Ft.
Garage	549 Sq. Ft.
Total Finished Area	2388 Sq. Ft.

### Exterior Dimensions

Width	72' 8"
Depth	59' 0"
Ridge Height <i>Calculated from main floor line</i>	28' 0"

### Default Construction Stats

*Stats are unique to the individual plan.*

Foundation Type	Basement
Exterior Wall Construction	2x4
Roof Pitches	10/12 Primary, 12/12 4/12 Secondary
Foundation Wall Height	9'
Main Wall Height	9'
Second Wall Height	8'

## Plan Description

The Bridgeport is a beautiful Modern Farmhouse style plan. The exterior features 3 dormers for that classic farmhouse look. You'll be blown away immediately when you step inside this home. The entry lies under beautiful exposed beams. Just to the right of the entryway is a formal dining room that is perfect for entertaining guests. The kitchen and great room lie under a soaring cathedral ceiling and flow perfectly in the open floor plan. The great room is warmed by a fireplace that is flanked by built-in bookshelves. The kitchen includes a large island and a walk-in pantry. The master suite is situated on the right side of the home and includes a soaking tub, his/her vanities, and a large walk-in closet that has access to the laundry room. On the left side of the home, you'll find 2 bedrooms, each with their own walk-in closet. A wonderful sunroom off the rear of the home leads to a large covered patio. An additional bonus room above the garage can add 380 sq ft of space and is perfect for a guest room or office. This home also has an optional finished basement that adds a theater room, a family room, a craft room, and an additional bedroom.