

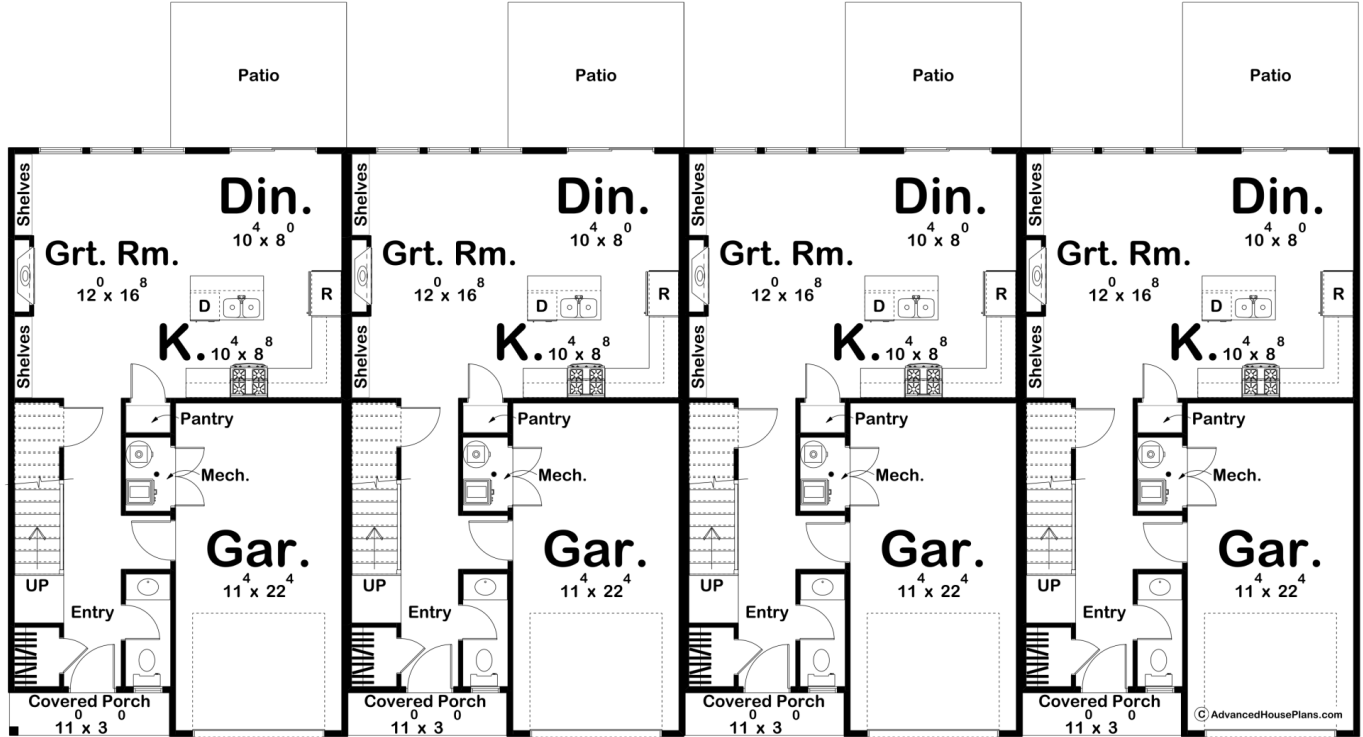

30629 - Buttonwood Data Sheet

1464 SQ FT	3 BEDS	3 BATHS	1 BAYS	92' 0" WIDE	40' 0" DEEP
---------------	-----------	------------	-----------	----------------	----------------

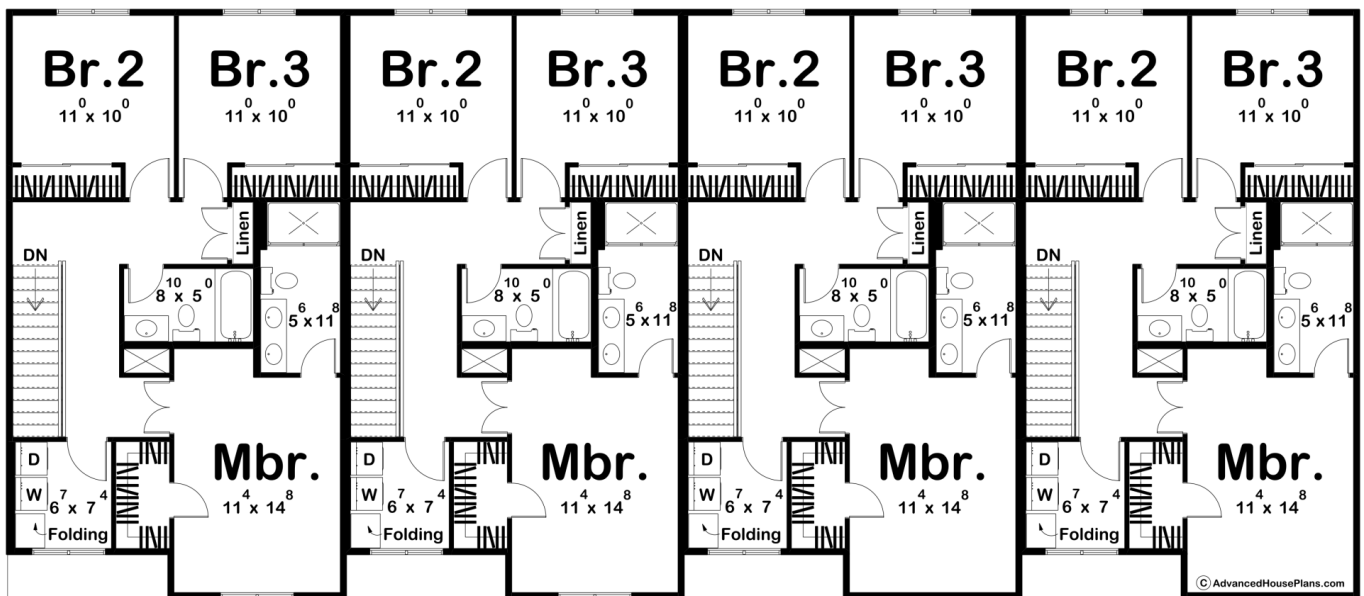



Construction Specs

Layout

Bedrooms	3
Bathrooms	3
Garage Bays	1

Square Footage

Main Level	622 Sq. Ft.
Second Level	842 Sq. Ft.
Covered Area	33 Sq. Ft.
Garage	264 Sq. Ft.
Total Finished Area	1464 Sq. Ft.

Exterior Dimensions

Width	92' 0"
Depth	40' 0"
Ridge Height	28' 0"
<i>Calculated from main floor line</i>	

Default Construction Stats
Stats are unique to the individual plan.

Foundation Type	Slab
Exterior Wall Construction	2x4
Roof Pitches	Primary 10/12, Secondary 6/12
Main Wall Height	9'
Second Wall Height	8'

Plan Description

Imagine coming home to your stunning two-story modern farmhouse townhouse, nestled in a serene neighborhood that perfectly balances contemporary design with rustic charm. As you approach, the clean lines and sleek finishes of the exterior, accented with traditional farmhouse elements immediately catch your eye. This unique blend of styles creates a visually striking and inviting presence, setting the tone for the exceptional living experience within. The Buttonwood is a quad-plex of our Tara Hills Plan. Step inside to discover an open-concept main area at the rear that effortlessly combines the living room, dining space, and kitchen into one harmonious flow. The kitchen features an island with seating, a separate pantry closet, and plenty of cabinet space for storage. Whether you're hosting a dinner party or enjoying a quiet evening at home, this versatile space is designed to accommodate your lifestyle with ease and elegance. Venture upstairs to find three bedrooms, each thoughtfully designed to offer comfort and privacy. The master suite is a true retreat, complete with a luxurious en-suite bathroom. The additional two bedrooms share a well-appointed bathroom at the rear of the home. Beyond the individual unit's appeal, the quadplex setup provides a unique opportunity for community living while maintaining personal space. Ideal for families, professionals, or investors, this modern farmhouse quadplex offers not just a home, but a lifestyle. The thoughtful design, combined with the practicality of multi-family living, makes it a standout choice in today's real estate market. Don't miss your chance to own a piece of this harmonious blend of modern luxury and timeless farmhouse charm!