

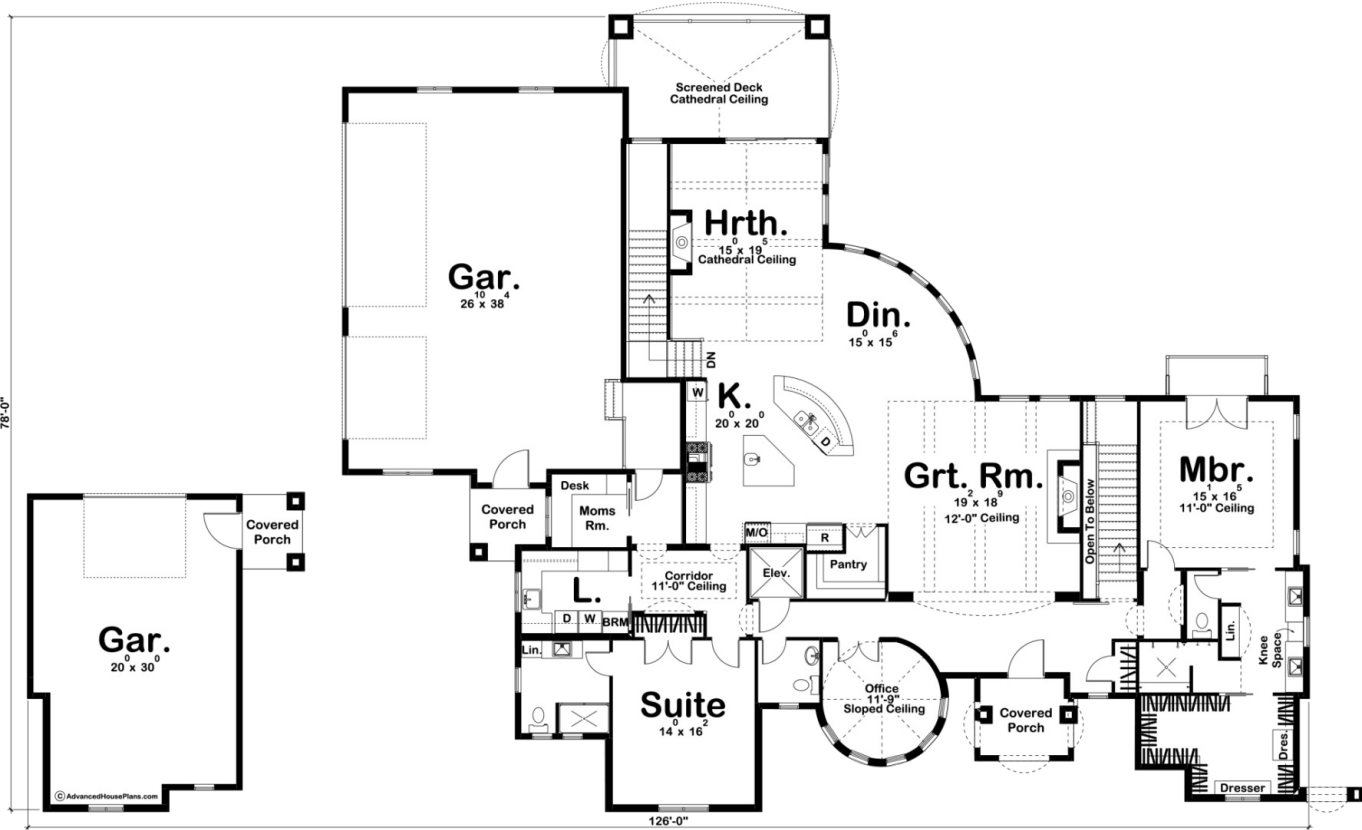

29519 - Chambers Bay Data Sheet

3211 SQ FT	2 BEDS	3 BATHS	4 BAYS	126' 0" WIDE	78' 0" DEEP
---------------	-----------	------------	-----------	-----------------	----------------



Construction Specs

Layout

Bedrooms

Bathrooms	3
Garage Bays	4
Square Footage	
Main Level	3211 Sq. Ft.
Garage	1721 Sq. Ft.
Total Finished Area	3211 Sq. Ft.
Exterior Dimensions	
Width	126' 0"
Depth	78' 0"
Ridge Height	30' 0"
<i>Calculated from main floor line</i>	
Default Construction Stats	
<i>Stats are unique to the individual plan.</i>	
Foundation Type	Basement
Exterior Wall Construction	2x4
Roof Pitches	Primary 12/12, Secondary 14/12 6/12
Foundation Wall Height	10'
Main Wall Height	10'

Plan Description

Classic French Country details dress the exterior of this 3,211 sq. ft., 1-story, 2- bedroom house plan. Once inside, guests are greeted by immediate views into the great room, with a fireplace beneath a high box-beamed ceiling. Adjacent to the great room, a formal dining room is brightened by an array of windows. Across from the dining room, the hearth room enjoys a 2nd fireplace under a box-beamed cathedral ceiling. Perfect for casual gatherings, the hearth room lies open to the kitchen and dining area. The kitchen enjoys ample counter space with 2 islands, including an island workspace and breakfast bar. Just off the kitchen, a utility area includes a laundry room and mom's room. The master suite includes a bathroom with his and her vanities and a walk-in shower as well as a massive walk in closet. On the other side of the residence, a second suite includes its own bathroom. An impressive office lies just down the hall from the second suite with a high sloped ceiling. This home features plenty of garage space with an attached 3 car and a detached oversized 1 car garage.