

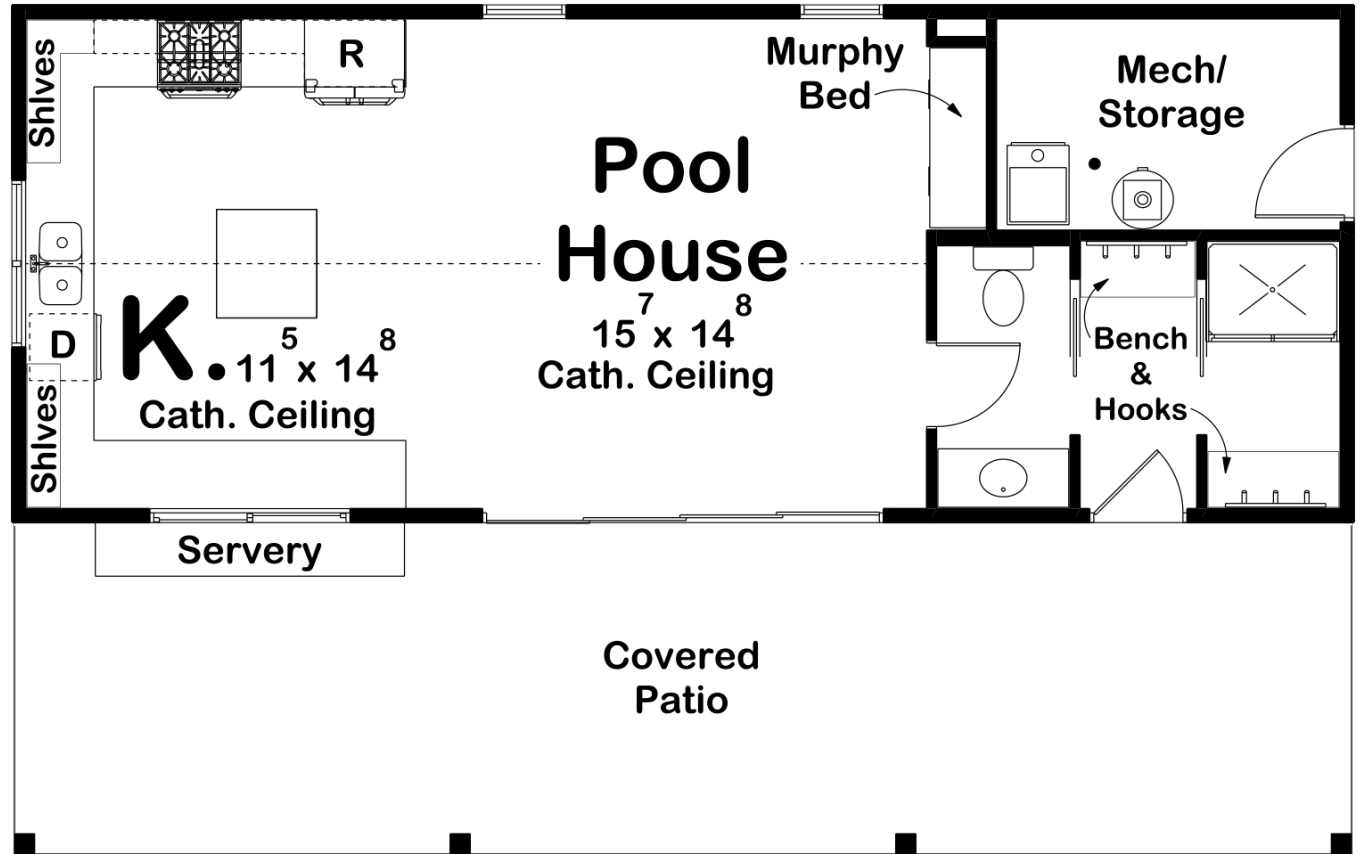

30254 - Cove Creek Data Sheet

542 SQ FT	0 BEDS	1 BATHS	0 BAYS	40' 0" WIDE	25' 4" DEEP
--------------	-----------	------------	-----------	----------------	----------------



Construction Specs

Layout

Bathrooms

Square Footage		
Main Level		542 Sq. Ft.
Covered Area		400 Sq. Ft.
Total Finished Area		542 Sq. Ft.
Exterior Dimensions		
Width		40' 0"
Depth		25' 4"
Ridge Height		17' 5"
<i>Calculated from main floor line</i>		
Default Construction Stats		
<i>Stats are unique to the individual plan.</i>		
Foundation Type		Slab
Exterior Wall Construction		2x4
Roof Pitches	Primary 10/12, Secondary 3/12	
Main Wall Height		10'

Plan Description

The Cove Creek is a cute modern farmhouse pool house with a large covered porch for all of your entertaining needs. The posts, exposed rafters, and wood brackets give this entry such a beautiful vibe. On the inside you will find a large sitting area that includes a murphy bed if you want to convert this into a guest house for the night. There is a full u-shaped kitchen equipped with a slider window that opens to the covered porch where you will find a snack bar. On the other side is a bathroom that is separated into three parts for the most convenience while entertaining at your pool. The stool and sink are in one room while the shower and bench are in another room. These two spaces are separated by an alley that connects to the outdoors and has a bench & hook space as well.