

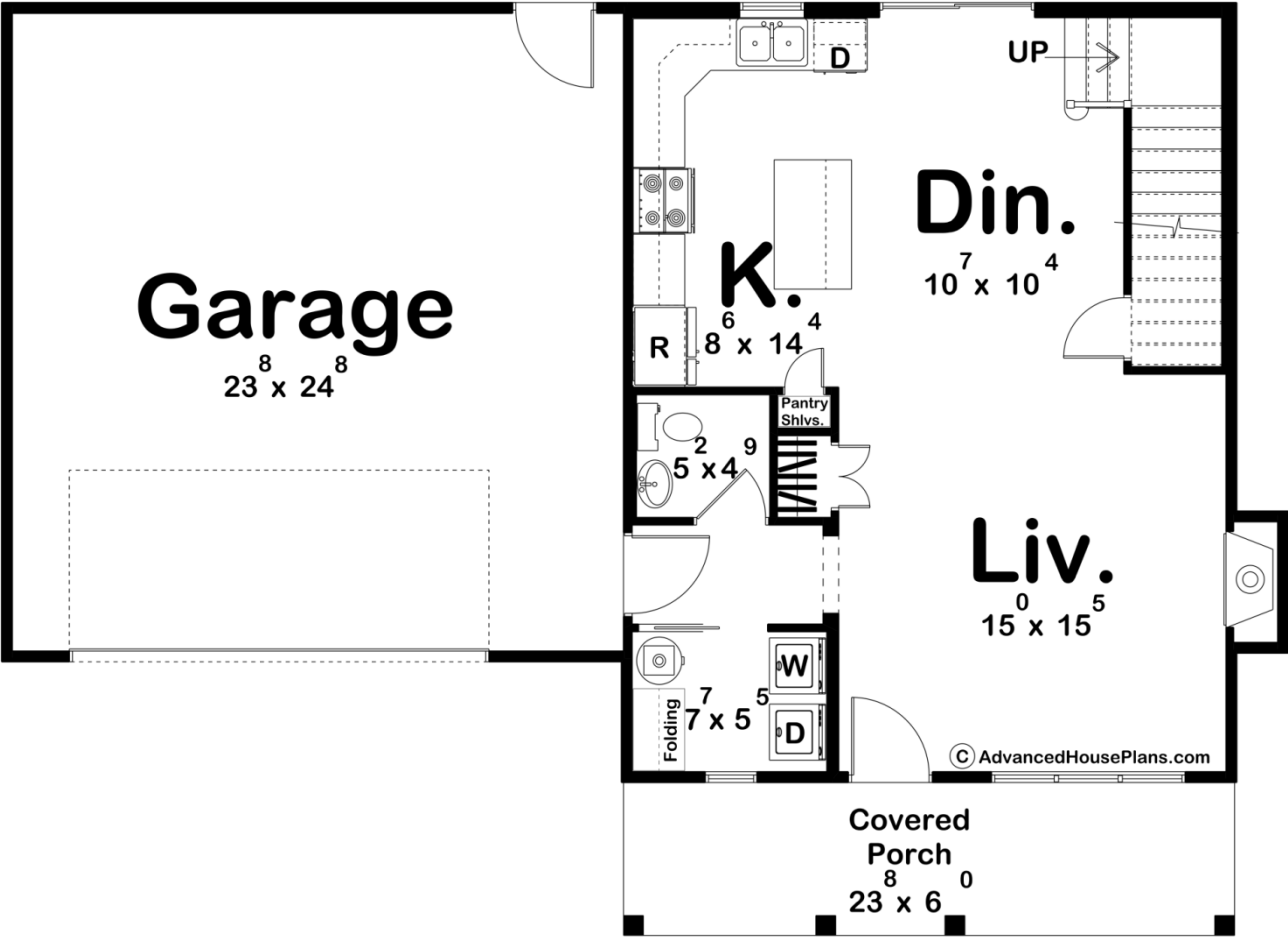

30688 - Grafton Data Sheet

1377 SQ FT	3 BEDS	3 BATHS	2 BAYS	49' 8" WIDE	36' 0" DEEP
---------------	-----------	------------	-----------	----------------	----------------

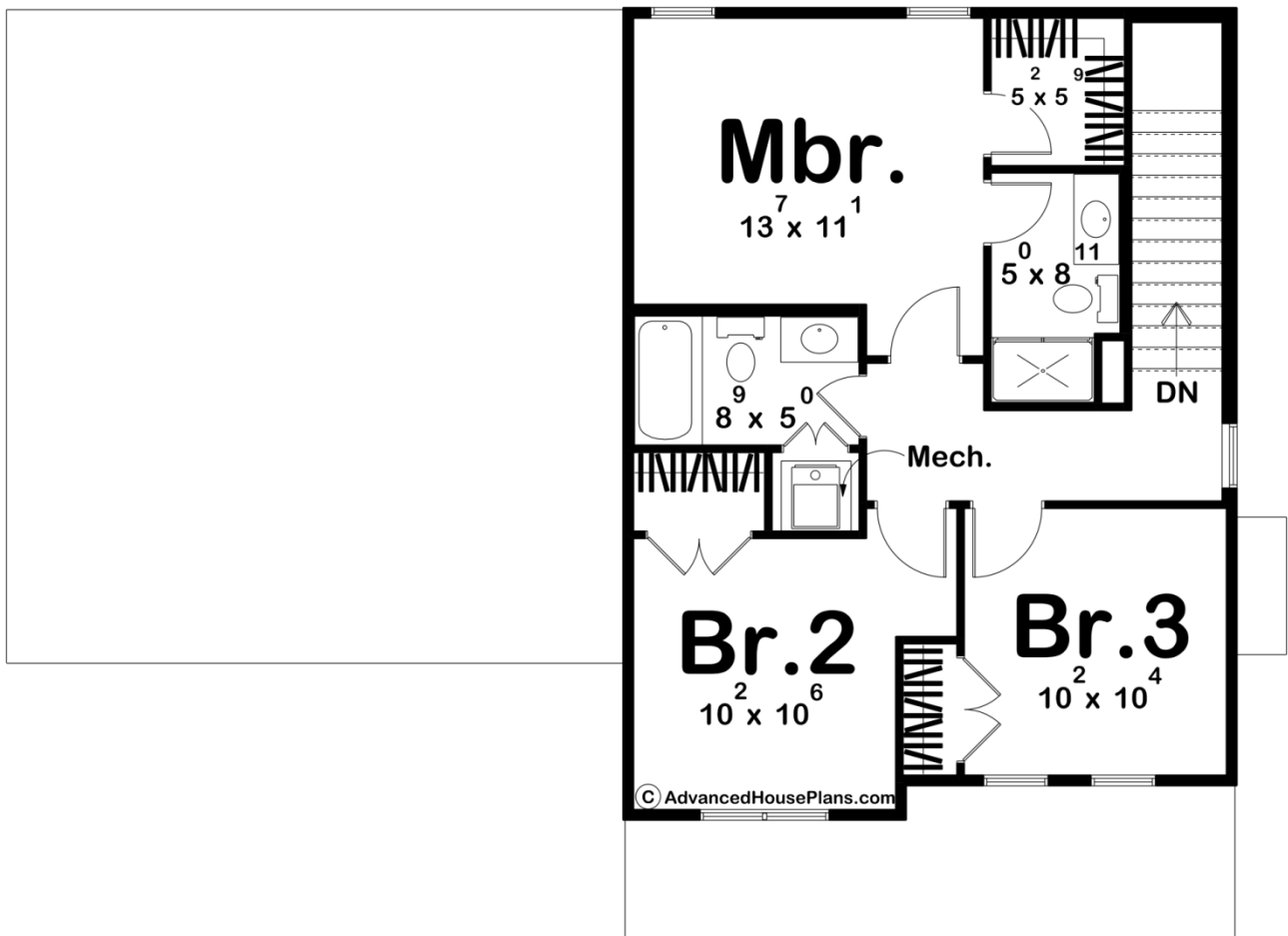



Construction Specs

Layout

Bedrooms	3
Bathrooms	3
Garage Bays	2

Square Footage

Main Level	710 Sq. Ft.
Second Level	667 Sq. Ft.
Covered Area	142 Sq. Ft.
Garage	608 Sq. Ft.
Total Finished Area	1377 Sq. Ft.

Exterior Dimensions

Width	49' 8"
Depth	36' 0"
Ridge Height	27' 8"
<i>Calculated from main floor line</i>	

Default Construction Stats
Stats are unique to the individual plan.

Foundation Type	Slab
Exterior Wall Construction	2x4
Roof Pitches	Primary 6/12, Secondary 4/12, 10/12
Main Wall Height	9'
Second Wall Height	9'

Plan Description

Welcome to the Grafton—a two-story traditional-style haven that combines charm, comfort, and practicality. From the moment you pull up, the curb appeal will captivate you with its classic lap siding and elegant wood-accented posts framing the covered front porch. It’s the perfect spot to relax and enjoy a peaceful morning or an evening breeze. Step through the front door, and you’re immediately welcomed into a spacious and open living room. This inviting space flows effortlessly into the dining area and kitchen, creating the perfect environment for hosting family gatherings, holiday dinners, or casual evenings with friends. With its open-concept design, this home ensures every space feels connected and vibrant. Conveniently located on the main floor, you’ll find a powder bathroom for guests and a laundry room, making everyday chores more manageable without interrupting the home’s flow. As you head upstairs, you’ll find three well-sized bedrooms, each with its own closet to keep everything organized. The master bedroom is truly a highlight, featuring a large walk-in closet and an en-suite bathroom, offering you a private retreat to unwind and recharge. The two-car garage is tucked neatly to the side, maintaining the home’s classic facade while giving you plenty of space for vehicles, storage, or hobbies. The home’s blend of style and functionality is designed to fit your lifestyle perfectly!