

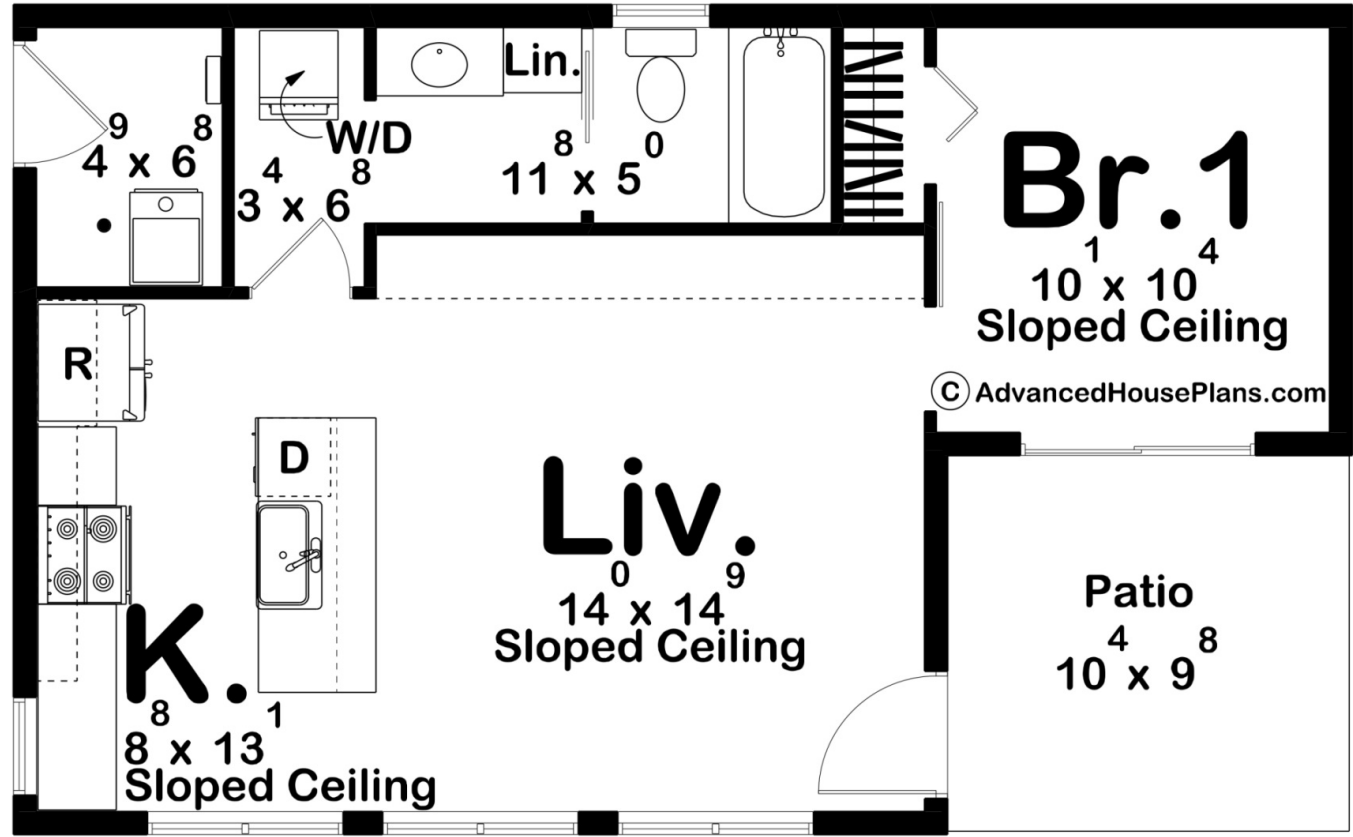

30554 - Huckleberry Data Sheet

583 SQ FT	1 BEDS	1 BATHS	0 BAYS	34' 0" WIDE	21' 0" DEEP
--------------	-----------	------------	-----------	----------------	----------------



Construction Specs

Layout

Bedrooms

Bathrooms	1
-----------	---

Square Footage

Main Level	583 Sq. Ft.
Total Finished Area	583 Sq. Ft.

Exterior Dimensions

Width	34' 0"
Depth	21' 0"
Ridge Height <i>Calculated from main floor line</i>	15' 4"

Default Construction Stats

*Stats are unique to the individual plan.*

Foundation Type	Slab
Exterior Wall Construction	2x4
Roof Pitches	Primary 3/12
Main Wall Height	8'

Plan Description

The Huckleberry ADU (Accessory Dwelling Unit) plan features a sleek, open-concept design that maximizes space and natural light. Upon entering, you’re welcomed into a bright living room with large, floor-to-ceiling windows. The living room opens to the outdoor patio, creating a seamless indoor-outdoor living experience. The kitchen, positioned adjacent to the living area, boasts a spacious island with ample counter space, perfect for dining or entertaining. A full bathroom includes a stacked washer and dryer for added convenience, while the private bedroom provides a cozy retreat, complete with large windows to flood the space with natural light. The Huckleberry combines functionality and modern design, making it ideal for small-scale living or guest accommodations.