

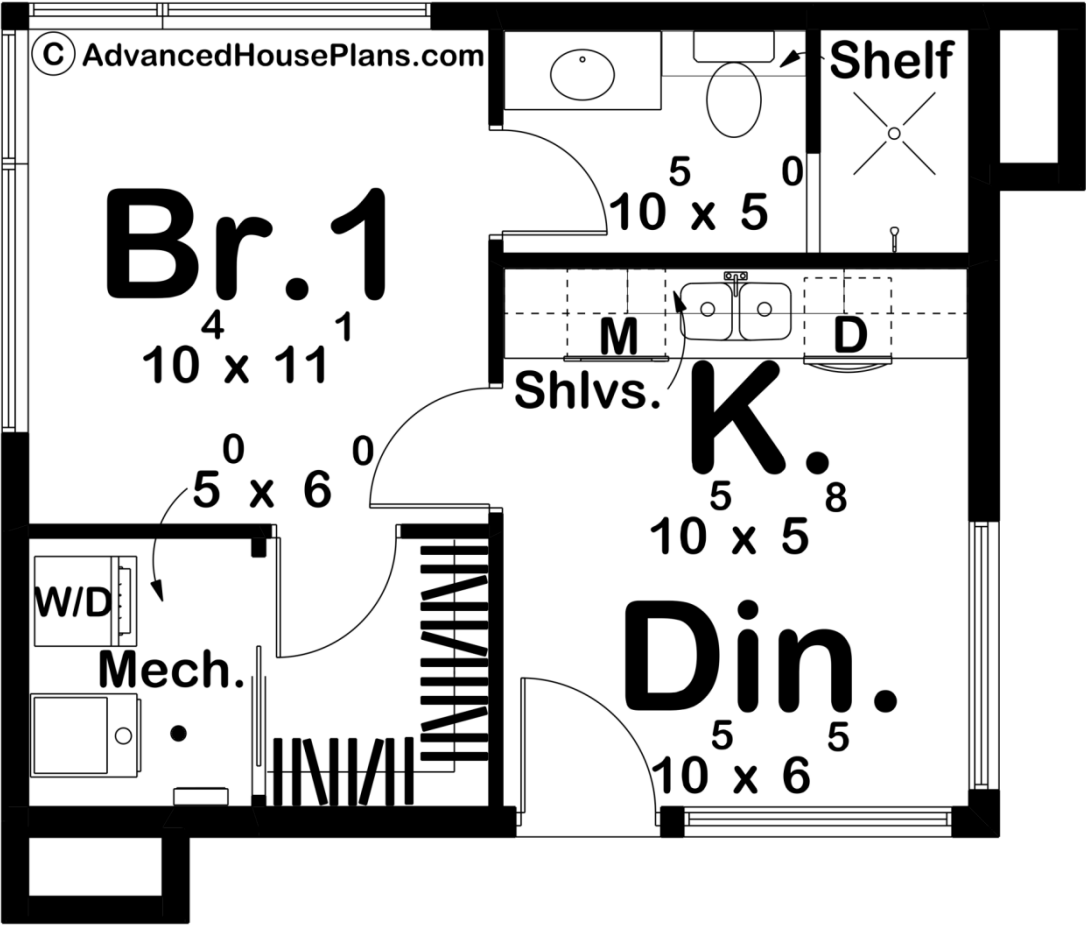

30569 - Kendric Data Sheet

373 SQ FT	1 BEDS	1 BATHS	0 BAYS	24' 0" WIDE	20' 4" DEEP
--------------	-----------	------------	-----------	----------------	----------------



Construction Specs

Layout

Square Footage

Main Level	373 Sq. Ft.
Total Finished Area	373 Sq. Ft.

Exterior Dimensions

Width	24' 0"
Depth	20' 4"
Ridge Height <i>Calculated from main floor line</i>	14' 1"

Default Construction Stats

Stats are unique to the individual plan.

Foundation Type	Slab
Exterior Wall Construction	2x6
Roof Pitches	Flat
Main Wall Height	10'

Plan Description

This cozy and stylish accessory dwelling unit (ADU) offers a seamless blend of modern comfort and rustic charm. As you step inside, you're welcomed into a bright and airy kitchenette and dinette area. Sleek cabinetry and efficient appliances in the kitchenette complement the clean, contemporary design, while a small dining nook provides just the right touch of functionality and warmth. Adjacent to the kitchenette, a tranquil bedroom invites relaxation with its minimalist yet cozy design. The room is bathed in natural light, thanks to modern windows that frame the surrounding scenery. Connected to the bedroom is a spacious full bathroom, featuring a walk-in shower, elegant fixtures, and thoughtful storage solutions for a luxurious yet practical retreat. The exterior showcases an eye-catching combination of stone accents and lap siding, blending traditional and contemporary aesthetics. Large, strategically placed modern windows create a harmonious connection between indoor and outdoor spaces. This thoughtfully designed ADU is the perfect mix of charm and modern living, making it an ideal addition to any property.