

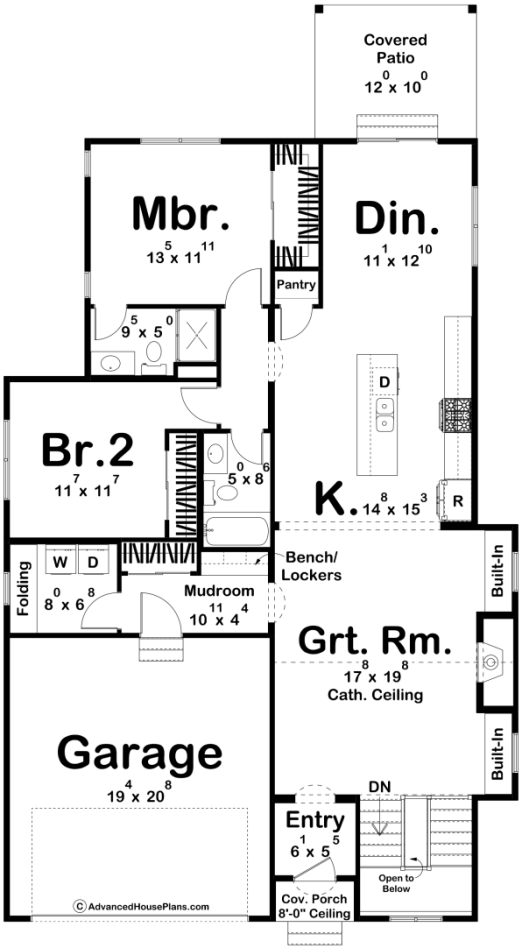

30557 - Lulworth Data Sheet

1546 SQ FT	2 BEDS	2 BATHS	2 BAYS	38' 0" WIDE	68' 0" DEEP
---------------	-----------	------------	-----------	----------------	----------------



Construction Specs

Layout

Bedrooms

Bathrooms	2
Garage Bays	2
Square Footage	
Main Level	1546 Sq. Ft.
Covered Area	138 Sq. Ft.
Garage	421 Sq. Ft.
Total Finished Area	1546 Sq. Ft.
Exterior Dimensions	
Width	38' 0"
Depth	68' 0"
Ridge Height	25' 0"
Calculated from main floor line	
Default Construction Stats	
Stats are unique to the individual plan.	
Foundation Type	Basement
Exterior Wall Construction	2x4
Roof Pitches	Primary 16/12, Secondary 6/12, Secondary 3/12
Foundation Wall Height	9'
Main Wall Height	9'

Plan Description

Imagine stepping into a charming, narrow Tudor home, where classic architectural details meet modern functionality. The distinctive exterior, with its steep gabled roofs, arched doorway, and beautiful wall detailing, welcomes you like a page out of an English fairy tale. Despite its cozy size, the home boasts a thoughtful layout that maximizes every inch of space, making it both intimate and inviting. The beauty of this Tudor is in its ability to combine old-world charm with contemporary living, perfect for someone who craves character without compromising on convenience. As you enter, the open-concept main area immediately enchants with a seamless flow between the living, dining, and kitchen spaces. Vaulted ceilings enhance the sense of space in the great room, while many windows flood the rooms with natural light, creating a warm and welcoming atmosphere. The kitchen is perfect for entertaining or preparing your favorite meals while staying connected with guests. Whether it's a cozy evening by the fireplace or a casual dinner party, this area is designed to feel spacious, yet snug, ideal for both relaxing and hosting. The home offers two beautifully appointed bedrooms, each a tranquil retreat from the bustle of daily life. The primary suite is a comfortable haven, complete with its own attached bathroom. The second bedroom is versatile and can serve as a guest room, home office, or even a personal gym. With its smart use of space and elegant finishes, this home provides just the right balance of luxury and practicality. This home is more than just a place to live; it's a storybook escape in a modern world, offering everything you need in a well-designed, compact space. Whether you're a first-time buyer or looking to downsize, this Tudor home is sure to capture your heart.