

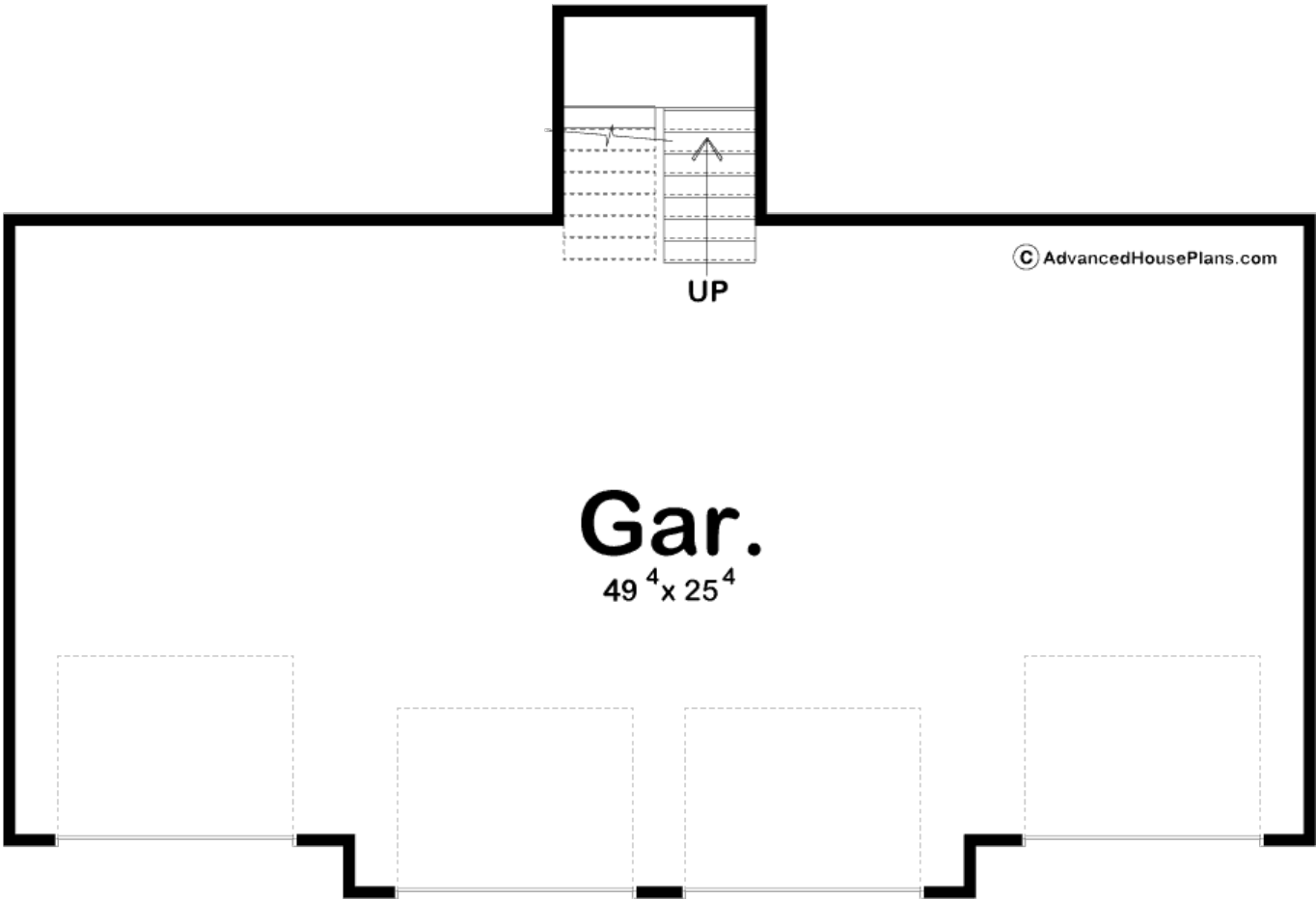

29231 - Newton Data Sheet

0 SQ FT	0 BEDS	0 BATHS	4 BAYS	50' 0" WIDE	34' 0" DEEP
------------	-----------	------------	-----------	----------------	----------------

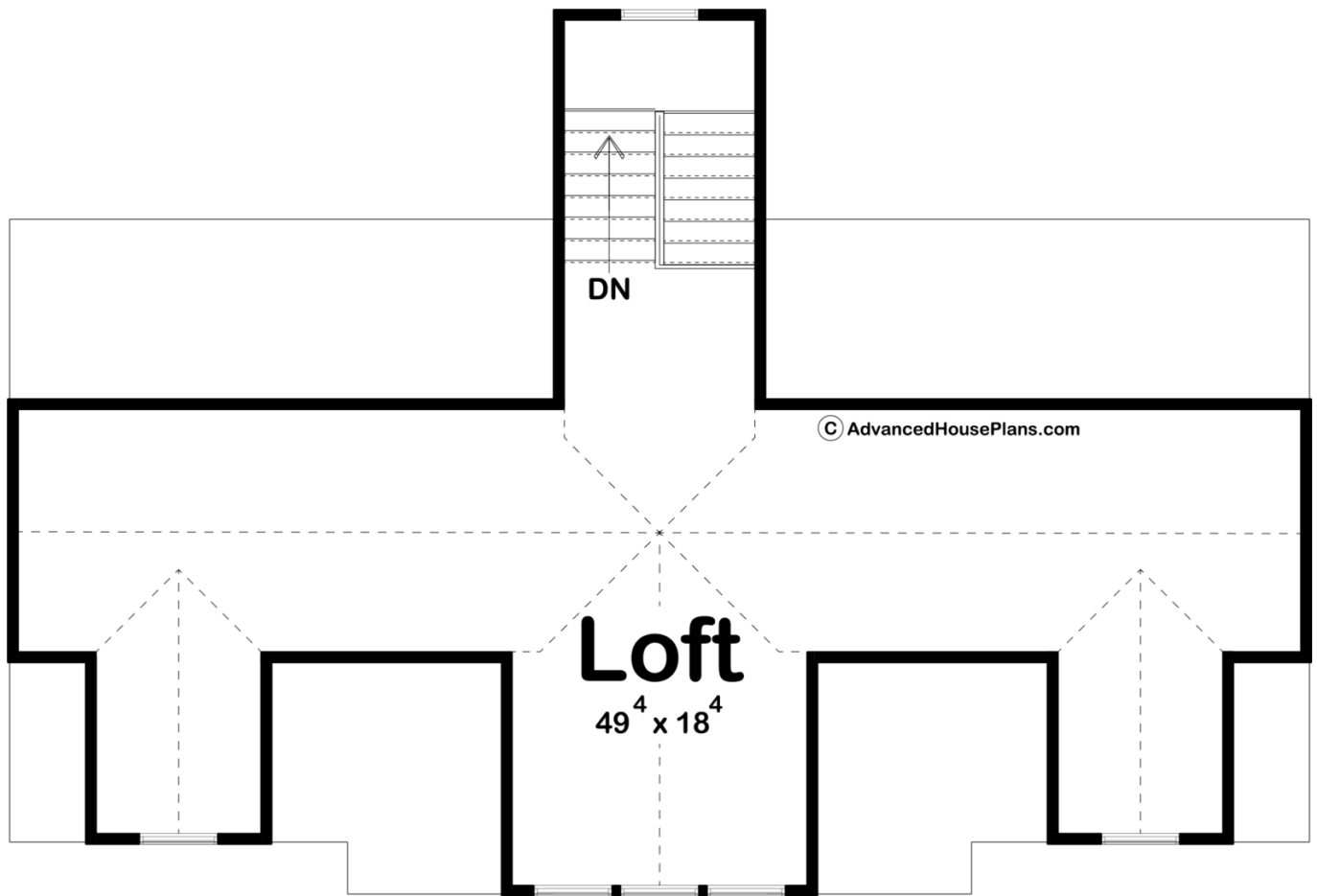



Construction Specs

Layout

Garage Bays 4

Square Footage

Garage 1312 Sq. Ft.

Exterior Dimensions

Width 50' 0"

Depth 34' 0"

Ridge Height 23' 0"
Calculated from main floor line

Default Construction Stats

Stats are unique to the individual plan.

Foundation Type Slab

Exterior Wall Construction 2x4

Roof Pitches 12/12 Primary

Main Wall Height 9'

Plan Description

This versatile and visually appealing garage plan features four spacious garage bays, providing ample room for multiple vehicles, recreational equipment, or workshop space. Adding to the interest of this garage is a spacious loft which provides a versatile area perfect for storage. The exterior showcases a charming blend of architectural styles, combining shake siding accents with a mix of board & batten and horizontal lap siding for a richly textured facade.