

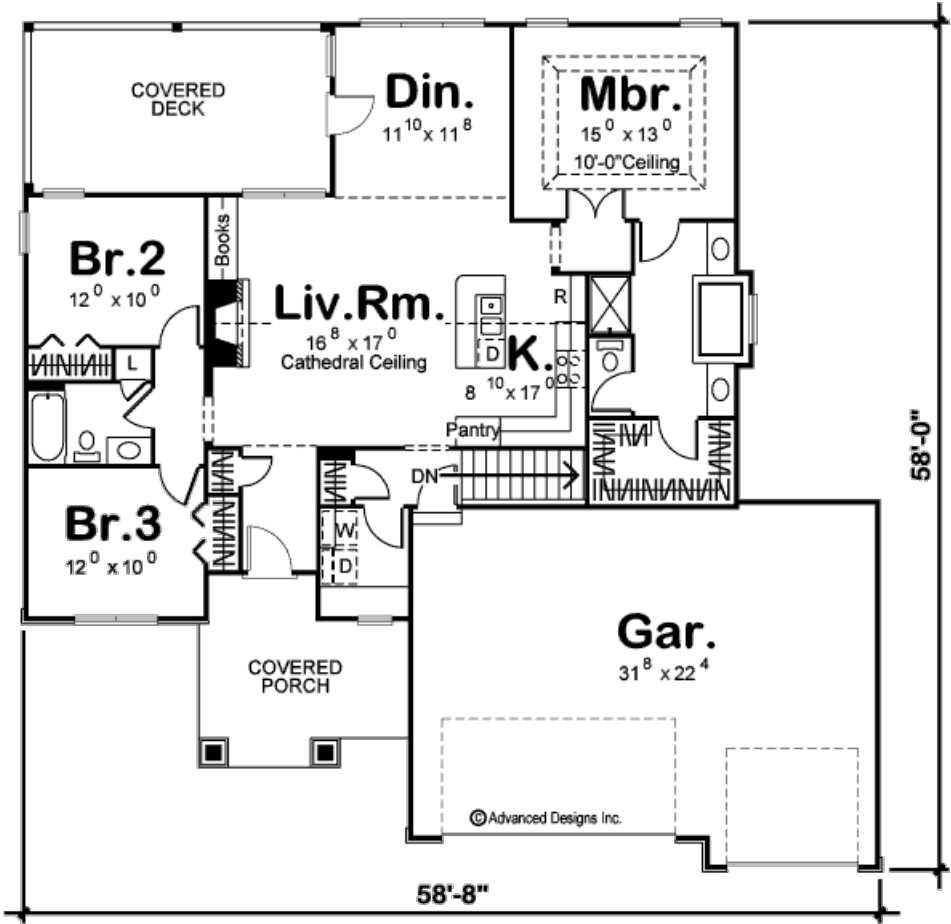

29194 - Picket Data Sheet

| | | | | | |
|---------------|-----------|------------|-----------|--------|--------|
| 1575 SQ FT | 3 BEDS | 2 BATHS | 3 BAYS | 58' 8" | 58' 0" |
| | | | | WIDE | DEEP |



Construction Specs

| |
|--------|
| Layout |
|--------|

Bedrooms

| | |
|--|--------------|
| Bathrooms | 2 |
| Garage Bays | 3 |
| Square Footage | |
| Main Level | 1575 Sq. Ft. |
| Garage | 763 Sq. Ft. |
| Total Finished Area | 1575 Sq. Ft. |
| Exterior Dimensions | |
| Width | 58' 8" |
| Depth | 58' 0" |
| Ridge Height <i>Calculated from main floor line</i> | 23' 0" |
| Default Construction Stats <i>Stats are unique to the individual plan.</i> | |
| Foundation Type | Basement |
| Exterior Wall Construction | 2x4 |
| Roof Pitches | 6/12 |
| Foundation Wall Height | 9' |
| Main Wall Height | 9' |

Plan Description

A tasteful blend of textures adorns the exterior of this 1,568 sq. ft., Traditional-style, 1-story house plan. Just inside from the deep covered front porch, the entry hall invites guests into the living room, with its cathedral ceiling, fireplace, and built-in bookcase. The kitchen and dining room share this open space for easy entertaining. The kitchen itself features an island workspace, wrapping counters, and a pantry. The adjacent dining area accesses a rear covered deck, perfect for enjoying meals outside. On the opposite side of the kitchen, a utility area intercepts outside traffic from the home's 3-car, front-load garage. Just off the kitchen, an alcove grants access to the private master suite, where the bedroom resides beneath a 10-foot-high ceiling. The bath area features his-and-her vanities, a soaking tub, shower, compartmented toilet and walk-in closet. Secondary bedrooms are found on the opposing side of the home, where they share a hall bath.

Traditional-style, 1-story house plan. Just inside from the deep covered front porch, the entry hall invites guests into the living room, with its cathedral ceiling, fireplace and built-in bookcase. The kitchen and dining room share this open space for easy entertaining. The kitchen itself features an island workspace, wrapping counters, and a pantry. The adjacent dining area accesses a rear covered deck, perfect for enjoying meals outside. On the opposite side of the kitchen, a utility area intercepts outside traffic from the home's 3-car, front-load garage. Just off the kitchen, an alcove grants access to the private master suite, where the bedroom resides beneath a 10-foot-high ceiling. The bath area features his-and-her vanities, a soaking tub, shower, compartmented toilet and walk-in closet. Secondary bedrooms are found on the opposing side of the home, where they share a hall bath.