

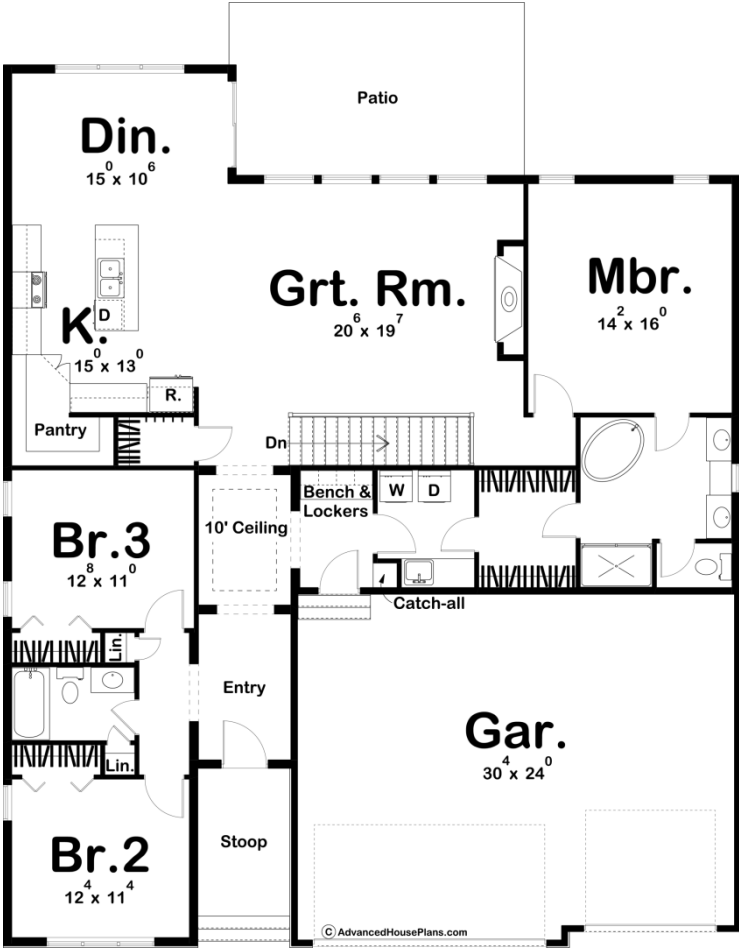

29926 - Riverside Data Sheet

| | | | | | |
|---------------|-----------|------------|-----------|----------------|----------------|
| 2012 SQ FT | 3 BEDS | 2 BATHS | 3 BAYS | 51' 0" WIDE | 66' 0" DEEP |
|---------------|-----------|------------|-----------|----------------|----------------|



Construction Specs

| |
|--------|
| Layout |
|--------|

Bedrooms

| | |
|--|--------------|
| Bathrooms | 2 |
| Garage Bays | 3 |
| Square Footage | |
| Main Level | 2012 Sq. Ft. |
| Covered Area | 258 Sq. Ft. |
| Garage | 756 Sq. Ft. |
| Total Finished Area | 2012 Sq. Ft. |
| Exterior Dimensions | |
| Width | 51' 0" |
| Depth | 66' 0" |
| Default Construction Stats <i>Stats are unique to the individual plan.</i> | |
| Foundation Type | Basement |
| Exterior Wall Construction | 2x4 |
| Roof Pitches | 4/12 Primary |
| Foundation Wall Height | 9' |
| Main Wall Height | 9' |

Plan Description

The Riverside plan is a Modern Prairie style house plan that features wood siding combined with stucco and glass garage doors. Just inside, the deeply recessed entry hall enjoys high, sculptured ceilings, and leads to an open arrangement of the kitchen, dining area, and great room, with expansive views to the outside. The kitchen includes a large working island and a walk-in pantry. The master suite is separated from the main living areas for privacy but can be accessed from two separate entry points for practicality. Bedrooms 2 and 3 also enjoy privacy from the rest of the home, as they are accessed just off the entry hall. The 3-car garage is accessed through a sensible mudroom with a bench, lockers, and handy catch-all cove.