

ADVANCED

HOUSE PLANS



30649 - Sagebrush Data Sheet

2436
SQ FT

3
BEDS

3
BATHS

3
BAYS

107' 0"
WIDE

49' 0"
DEEP

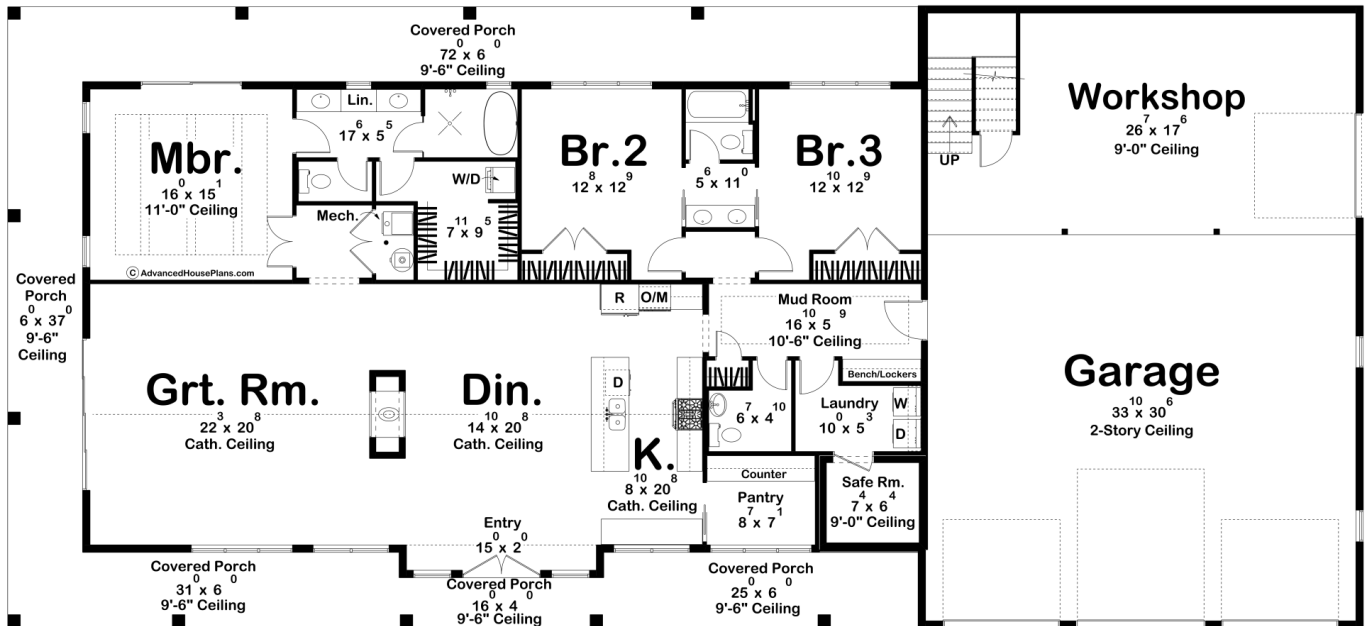

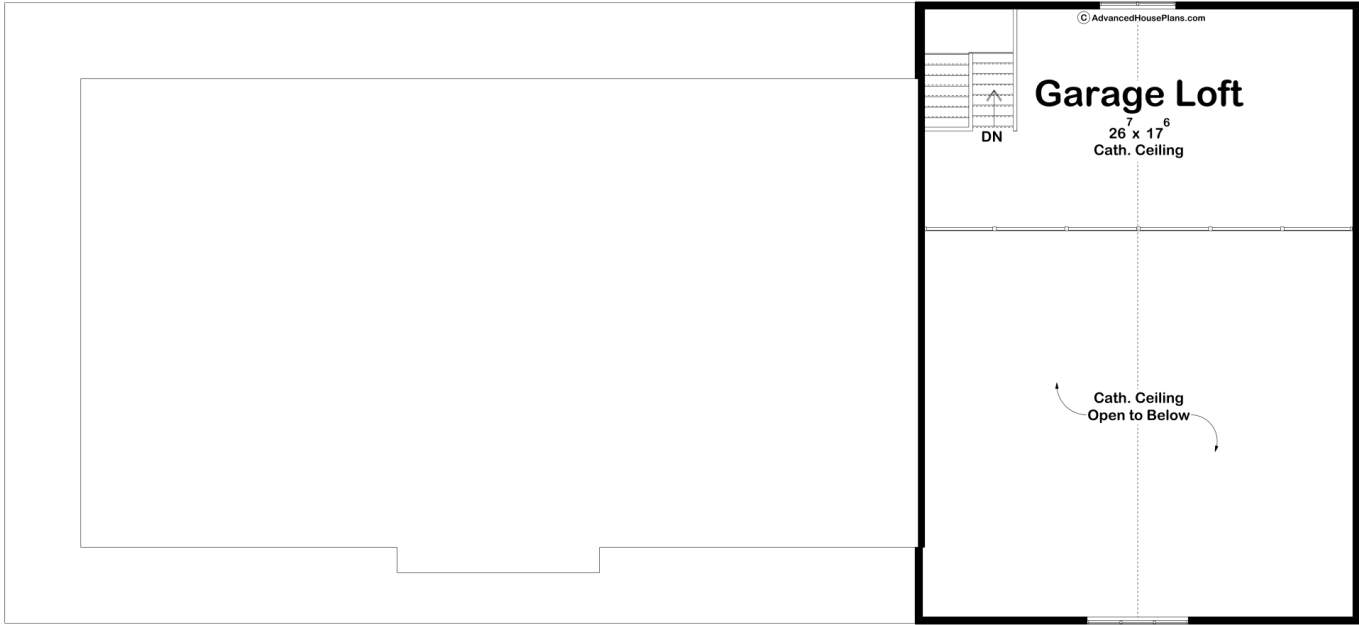

Construction Specs

Layout		
Bedrooms		3
Bathrooms		3
Garage Bays		3
Square Footage		
Main Level		2436 Sq. Ft.
Covered Area		1054 Sq. Ft.
Garage		1067 Sq. Ft.
Total Finished Area		2436 Sq. Ft.
Exterior Dimensions		
Width		107' 0"
Depth		49' 0"
Ridge Height		28' 5"
<i>Calculated from main floor line</i>		

Default Construction Stats
Stats are unique to the individual plan.

Foundation Type	Slab
Exterior Wall Construction	2x6
Roof Pitches	Primary 8/12, Secondary 10/12, 3/12, 6/12
Main Wall Height	10'
Second Wall Height	6'

Plan Description

This single-story barndominium-style house plan combines rustic charm with modern functionality. The exterior features classic board-and-batten siding complemented by steel panel roofing and wood accents, giving it a cozy yet durable feel. A massive wrap-around porch encircles the home, perfect for outdoor living and relaxation. The front of the home includes a three-car garage with a spacious workshop, and above the garage, an upstairs loft serves as a lounge area overlooking the entire garage space. Inside, the heart of the home is an expansive open-concept living area where the kitchen, dining room, and great room flow seamlessly under a grand cathedral ceiling. A dual-sided fireplace divides the dining room and the great room, providing warmth and ambiance to both spaces. The home offers three bedrooms, including a well-appointed master suite. A key feature is the safe room, providing security and peace of mind. This barndominium plan offers a perfect balance of rustic aesthetics and modern convenience, making it an ideal home for living.