

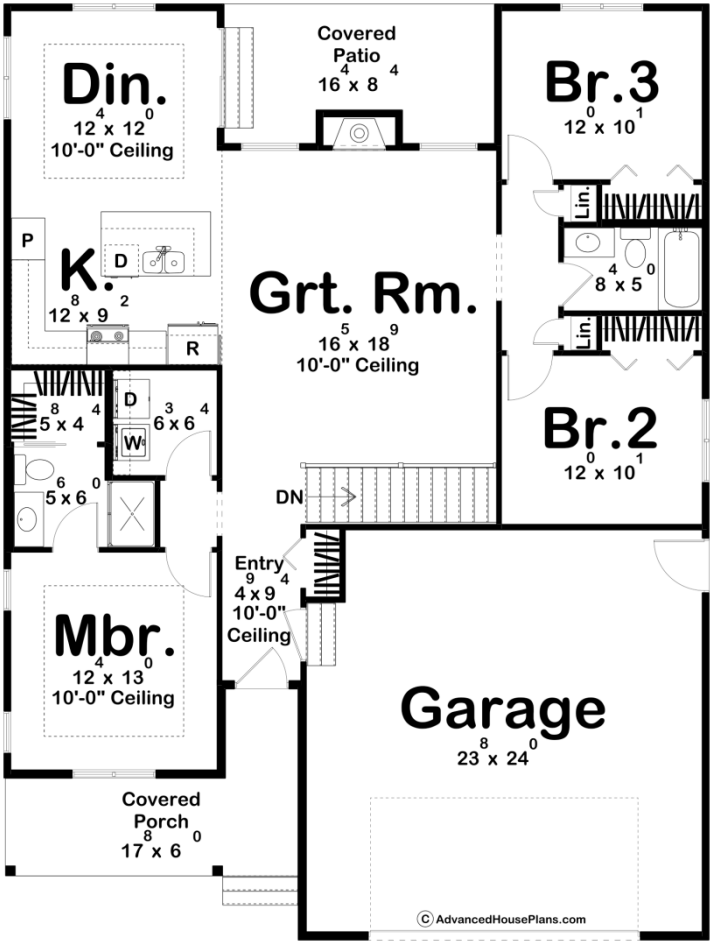

30472 - Springview Data Sheet

1436 SQ FT	3 BEDS	2 BATHS	2 BAYS	42' 0" WIDE	55' 8" DEEP
---------------	-----------	------------	-----------	----------------	----------------



Construction Specs

Layout
--------

Bedrooms

Bathrooms	2
Garage Bays	2
<b>Square Footage</b>	
Main Level	1436 Sq. Ft.
Covered Area	267 Sq. Ft.
Garage	580 Sq. Ft.
Total Finished Area	1436 Sq. Ft.
<b>Exterior Dimensions</b>	
Width	42' 0"
Depth	55' 8"
Ridge Height <i>Calculated from main floor line</i>	19' 0"
<b>Default Construction Stats</b> <i>Stats are unique to the individual plan.</i>	
Foundation Type	Basement
Exterior Wall Construction	2x4
Roof Pitches	Primary 5/12, Secondary 8/12, 3/12
Foundation Wall Height	9'
Main Wall Height	9'

## Plan Description

Discover the perfect blend of comfort and style in this beautiful modern farmhouse style home. This charming 3-bedroom, 2-bath ranch-style home boasts an inviting open floor plan that effortlessly blends style and comfort. Step into the spacious great room, where a cozy fireplace serves as the focal point, perfect for gathering with family and friends. The seamless flow connects the great room to the well-appointed kitchen and dining area, making it ideal for entertaining.The master bedroom, conveniently located next to the entry, features a raised tray ceiling that enhances the sense of space and elegance. Enjoy the luxurious master bath, complete with a walk-in closet that provides ample storage. Two additional bedrooms offer versatility, whether for family, guests, or a home office.This home’s modern farmhouse aesthetic is complemented by thoughtful details throughout, creating a warm and inviting atmosphere. Discover the perfect blend of contemporary design and timeless charm in this beautiful ranch-style retreat.