

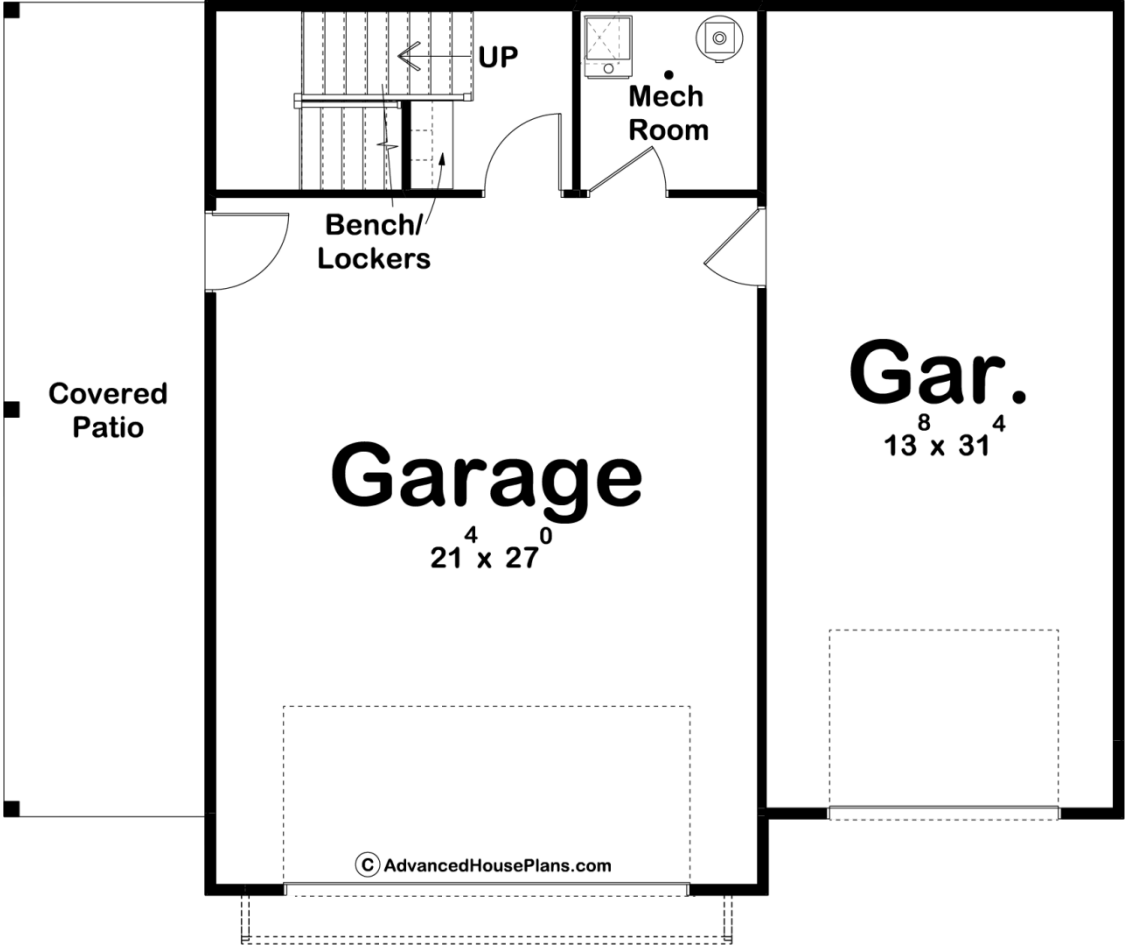

29967 - Willow Point Data Sheet

807 SQ FT	1 BEDS	1 BATHS	3 BAYS	44' 0" WIDE	35' 0" DEEP
--------------	-----------	------------	-----------	----------------	----------------

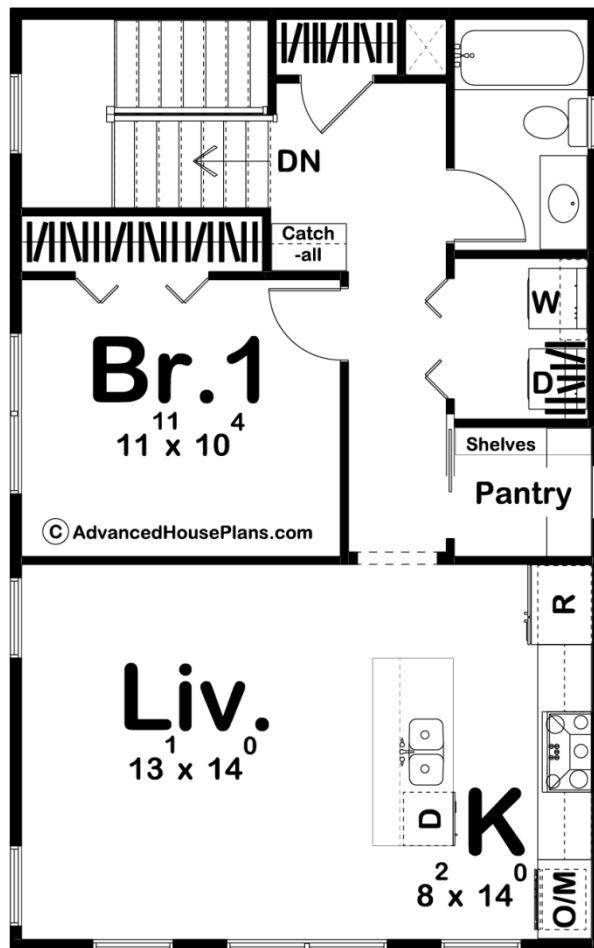



## Construction Specs

### Layout

Bedrooms	1
Bathrooms	1
Garage Bays	3

### Square Footage

Main Level	106 Sq. Ft.
Second Level	701 Sq. Ft.
Covered Area	256 Sq. Ft.
Garage	1056 Sq. Ft.
Total Finished Area	807 Sq. Ft.

### Exterior Dimensions

Width	44' 0"
Depth	35' 0"
Ridge Height	28' 0"
<i>Calculated from main floor line</i>	

**Default Construction Stats**  
*Stats are unique to the individual plan.*

Foundation Type	Slab
Exterior Wall Construction	2x4
Roof Pitches	8/12 Primary, 3/12 Secondary
Main Wall Height	9'
Second Wall Height	9'

**Plan Description**

Modern farmhouse styling gives the Willow Point excellent curb appeal. The exterior highlights beautiful wood accents and garage doors with board and batten siding. This carriage house plan features a 3 car garage on the main level with an apartment above. The apartment includes 1 bedroom and 1 bathroom. The living room and kitchen are arranged in an open layout. The kitchen features an island and a walk-in pantry.